

■ Metal reservoirs

4ℓ



■ Model

Applicable pump	Model	Part Number	Pump position	Mounting	Oil level switch
AMZ100S AMO AMR-III -150	T-80L-AOF	104386	Right	Foot	—
	T-80L-AOB	104486	Right	Back	—
MMXL-III MMX-II AMS PM-8S	T-80L-LXF	104373	Left	Foot	—
	T-80L-LXB	104473	Left	Back	—
	T-80L-RXF	104374	Right	Foot	—
	T-80L-RXB	104474	Right	Back	—
AMI-300S AMI-300	T-80L-LHF	104378	Left	Foot	Without
	T-80L-LHB	104478	Left	Back	Without
	T-80L-RHF	104379	Right	Foot	Without
	T-80L-RHB	104479	Right	Back	Without
	T-80L-OLHF	104384	Left	Foot	With
	T-80L-OLHB	104484	Left	Back	With
	T-80L-ORHF	104385	Right	Foot	With
	T-80L-ORHB	104485	Right	Back	With
AMI-1000S AMI-1000	T-80L-LKF	104376	Left	Foot	Without
	T-80L-LKB	104476	Left	Back	Without
	T-80L-RKF	104377	Right	Foot	Without
	T-80L-RKB	104477	Right	Back	Without
	T-80L-OLKF	104382	Left	Foot	With
	T-80L-OLKB	104482	Left	Back	With
	T-80L-ORKF	104383	Right	Foot	With
	T-80L-ORKB	104483	Right	Back	With
ACM-II AM ADM	T-80L-LAF	104371	Left	Foot	Without
	T-80L-LAB	104471	Left	Back	Without
	T-80L-RAF	104372	Right	Foot	Without
	T-80L-RAB	104472	Right	Back	Without
	T-80L-OLAF	104380	Left	Foot	With
	T-80L-OLAB	104480	Left	Back	With
	T-80L-ORAF	104381	Right	Foot	With
	T-80L-ORAB	104481	Right	Back	With

Material: SPCC Total capacity: 12.3L Useful capacity: 8.0L Coating color: Silver

Dimensional drawing

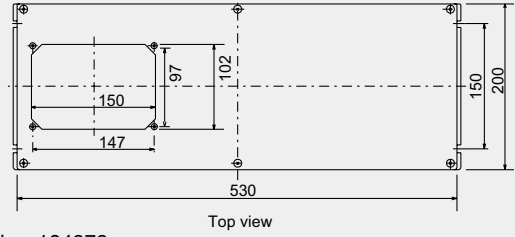
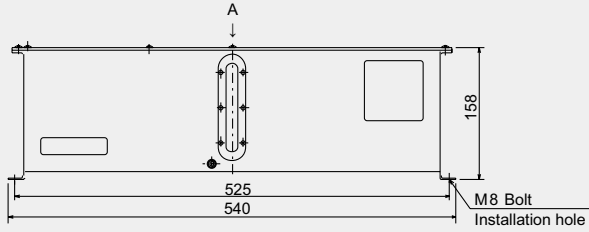

[T-80L-LXF]Part Number 104373

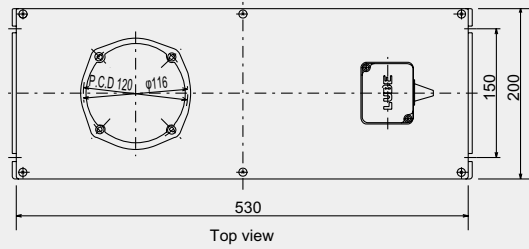
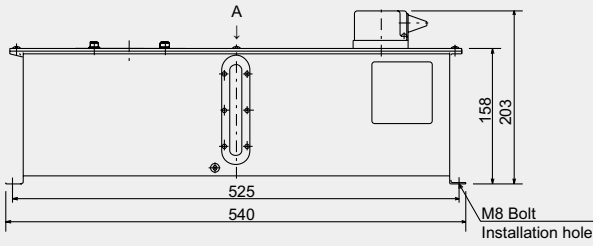

[T-80L-OLAF]Part Number 104380

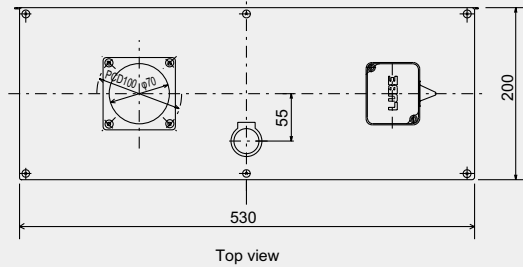
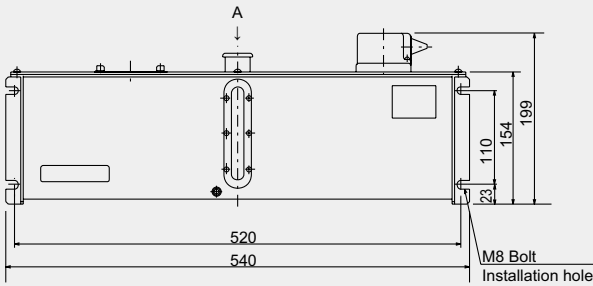

[T-80L-OLHB]Part Number 104484

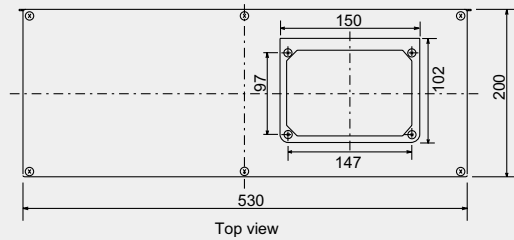
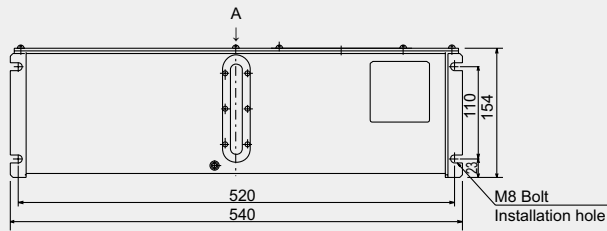

[T-80L-AOB]Part Number 104486